

360 DUTCH AXIS

Jan 02

If you are missing any of the following items, please contact Stanton Video immediately. (602) 493-9505

- 1. Dutch Axis Assembly
- 2. High Speed Motor
- 3. Motor Controller
- 4. DC Power Supply
- 5. Control Cable
- 6. Motor Extensions
- 7. Dutch Rocker Pot
- 8. Camera Accessory Extensions

MAXIMUM CAMERA WEIGHT.....25lbs, 11.3kg

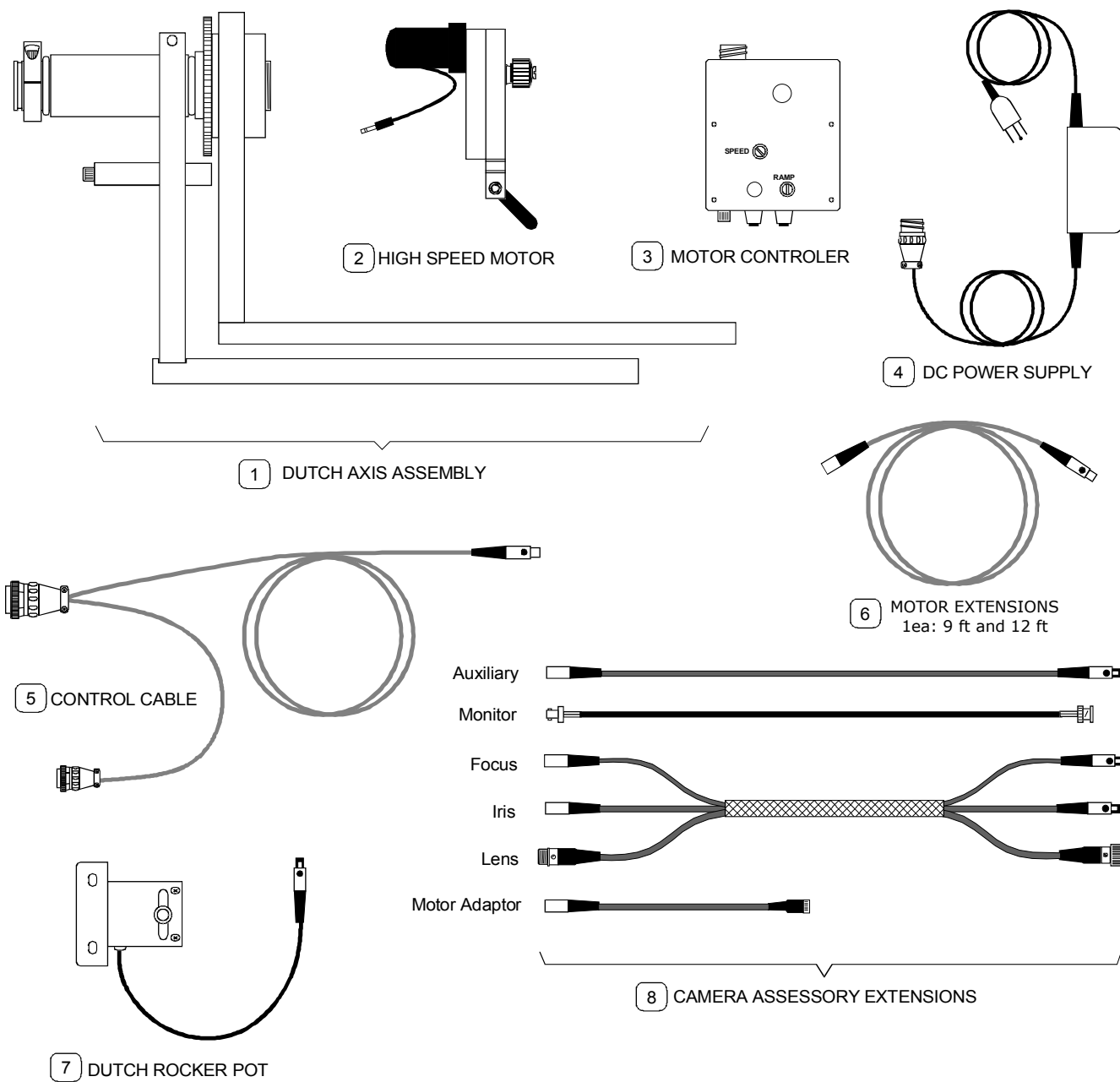

CAMERA PLATFORM ASSEMBLY

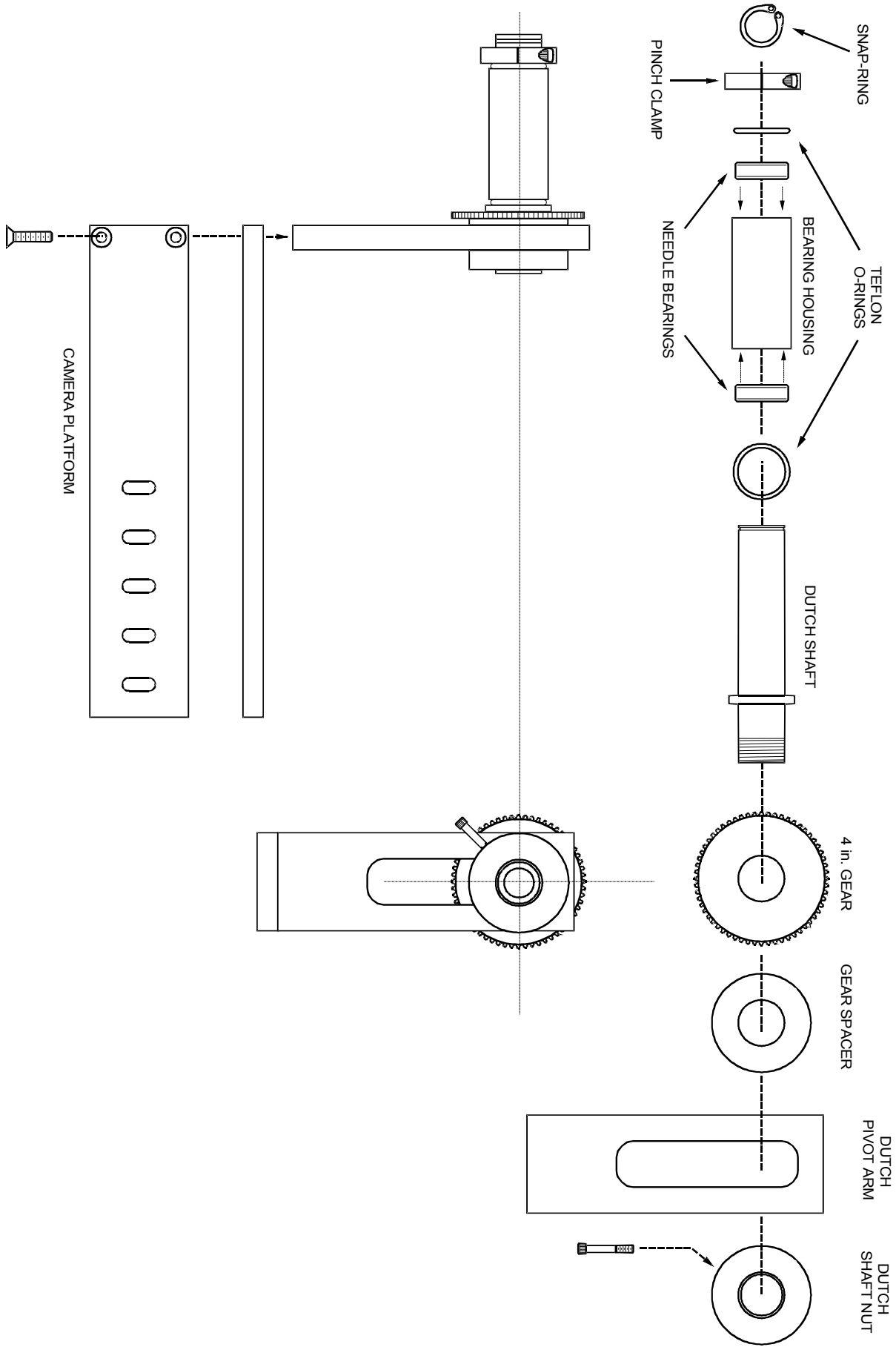

ASSEMBLY DRAWING

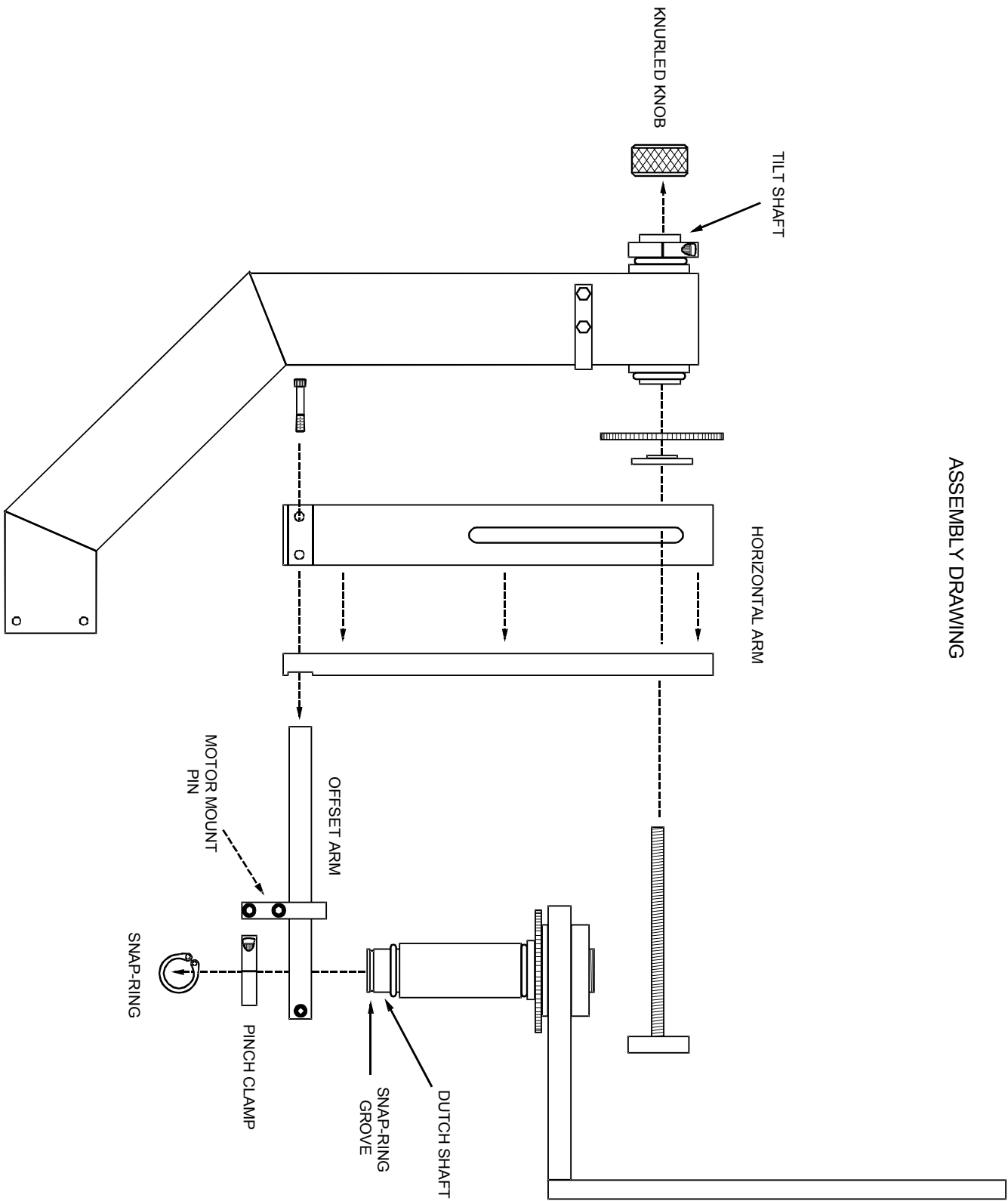

ASSEMBLY

1. Remove the Swing Arm Assembly from the Head by unscrewing the Knurled Knob and removing the Tilt Stud.

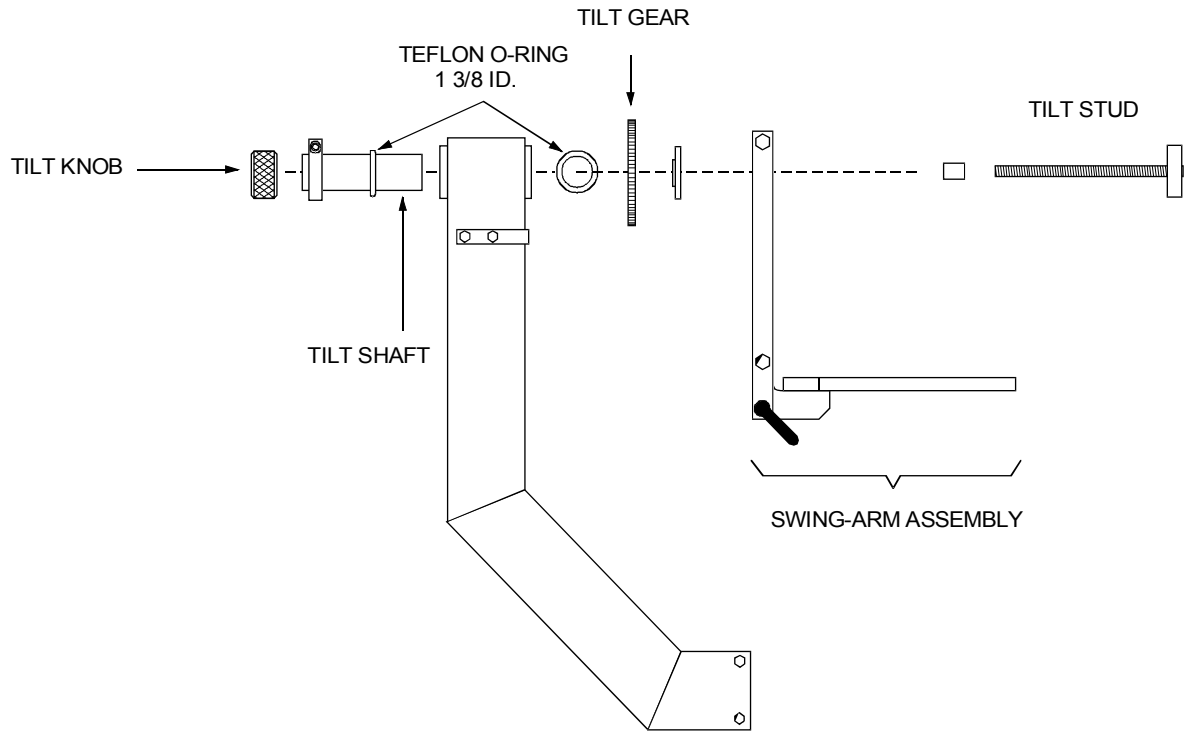

2. Install the Dutch Axis Assembly in place of the Swing Arm and attach using the Tilt Stud and Tilt Knob.

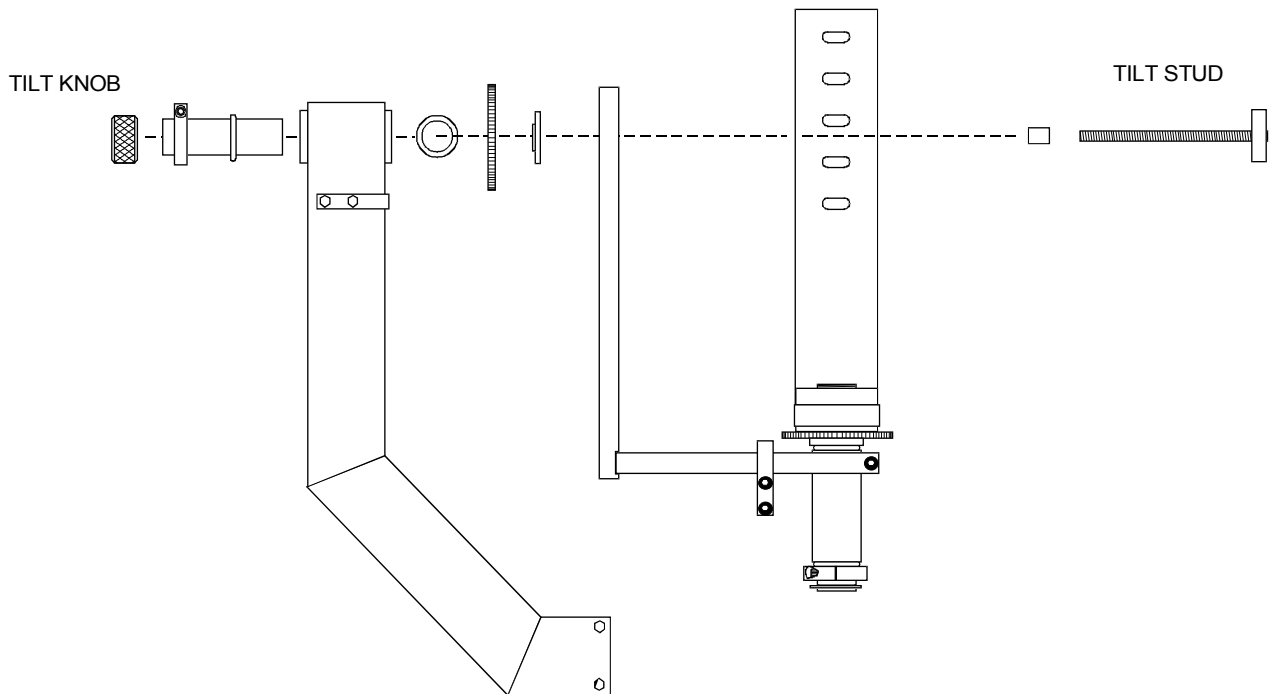

- 3: Most of the electrical cables must be extended by routing the Camera Accessory Extensions through the hollow dutch shaft. Insert the largest connectors first as shown below.

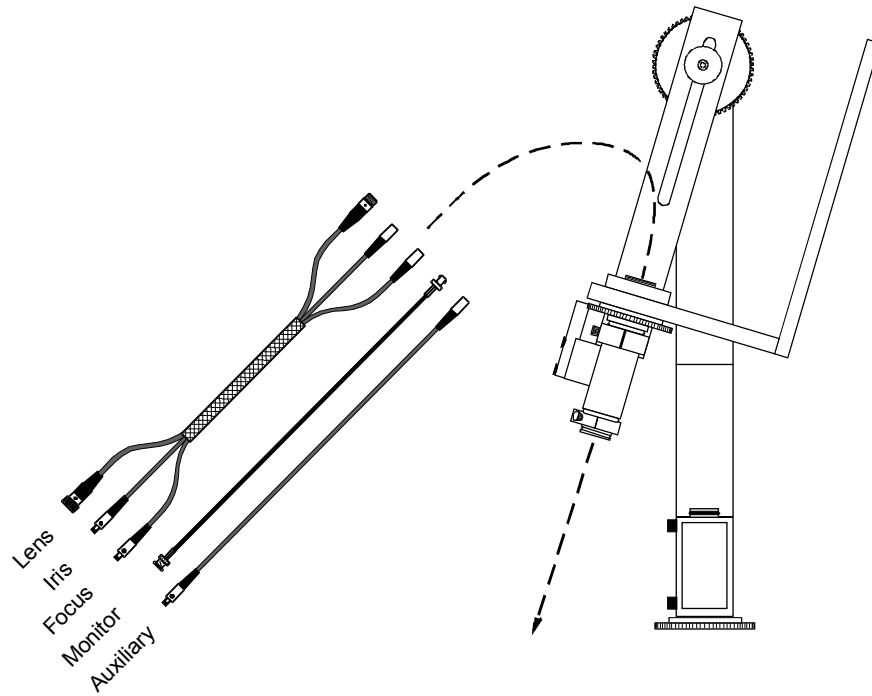

4. Mount the camera as close to the back of the camera platform as possible. Always use two Camera Knobs to prevent the camera from twisting during the dutching operation.

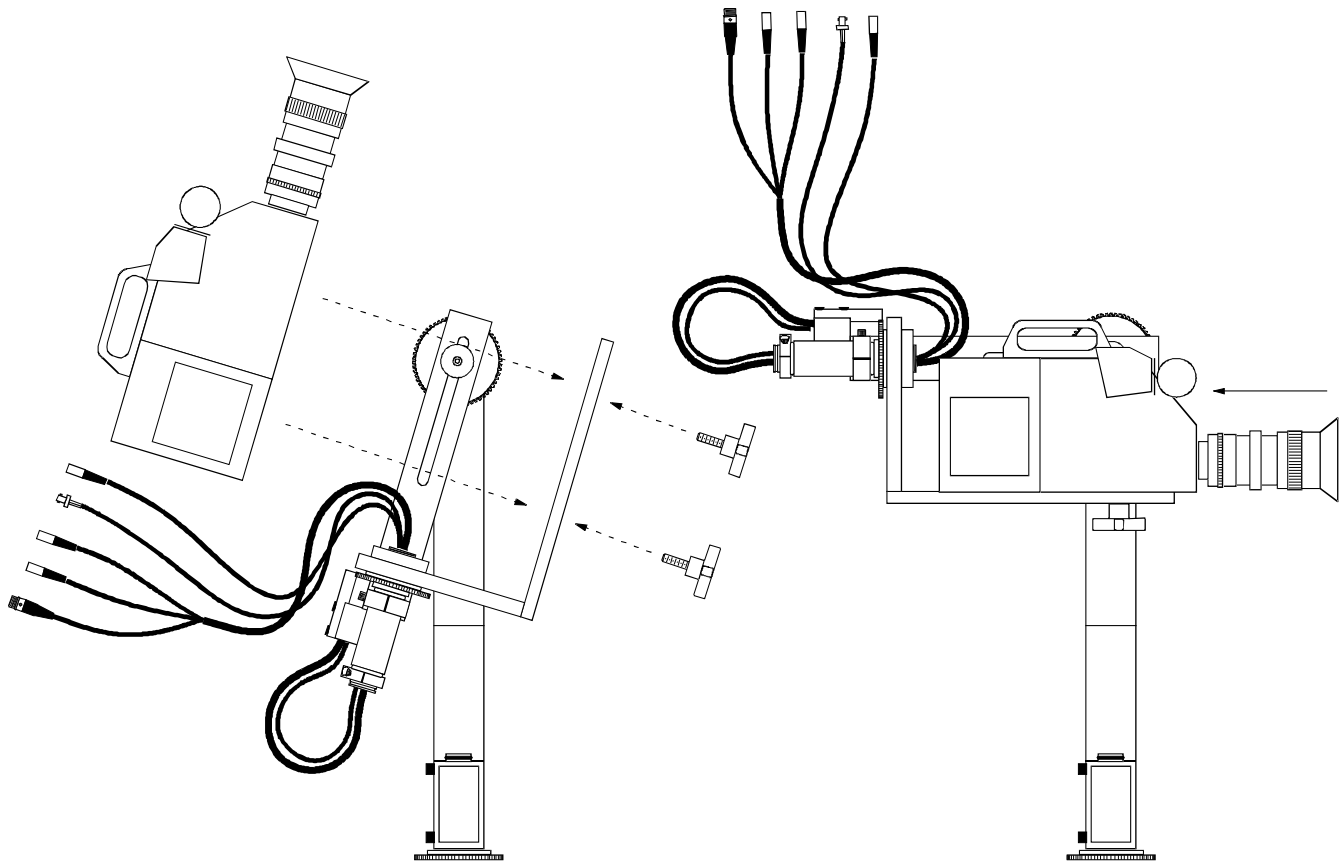

- 5: Attach the Dutch Motor to the Motor Mount Pin. The Iris and Focus servos should also be attached before you balance the camera.

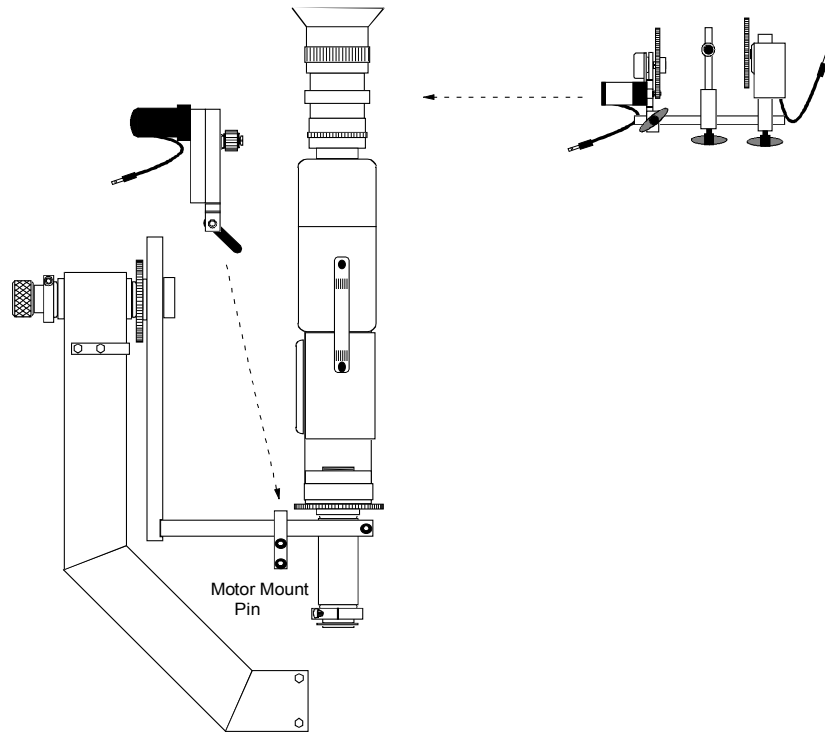

BALANCING THE CAMERA

Balancing the camera is accomplished in the same manner as the standard head, except that there is a second axis to balance. The Dutch and Pan motors must not be engaged when balancing the camera.

1. Horizontal Balance: loosen the knurled knob and slide the Dutch Assembly fore and aft along the slot in the Horizontal Arm, until the camera remains level.

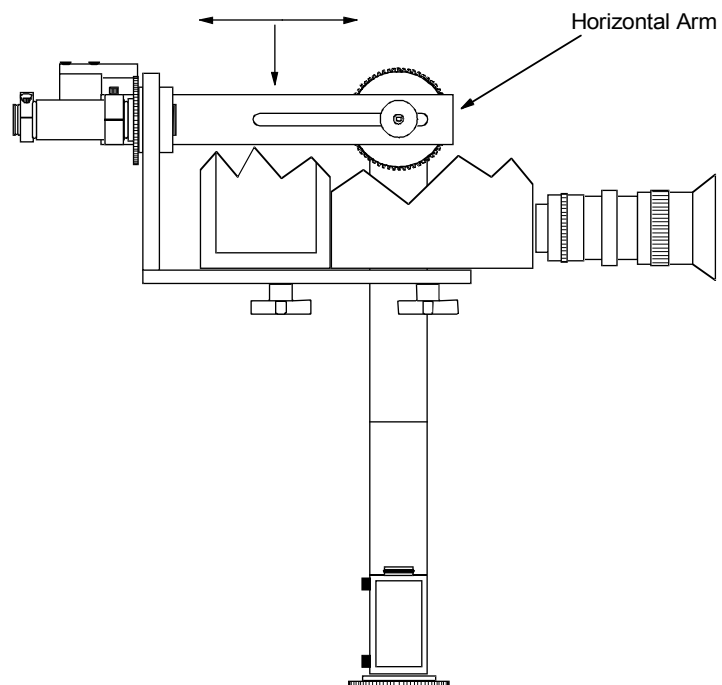

- 2: Vertical Balance: Loosen the large circular Dutch Shaft Nut so that the Dutch Pivot Arm can move vertically. Slide the camera vertically until it is in balance. It may also be necessary to slide the camera sideways using the slots in the camera platform.

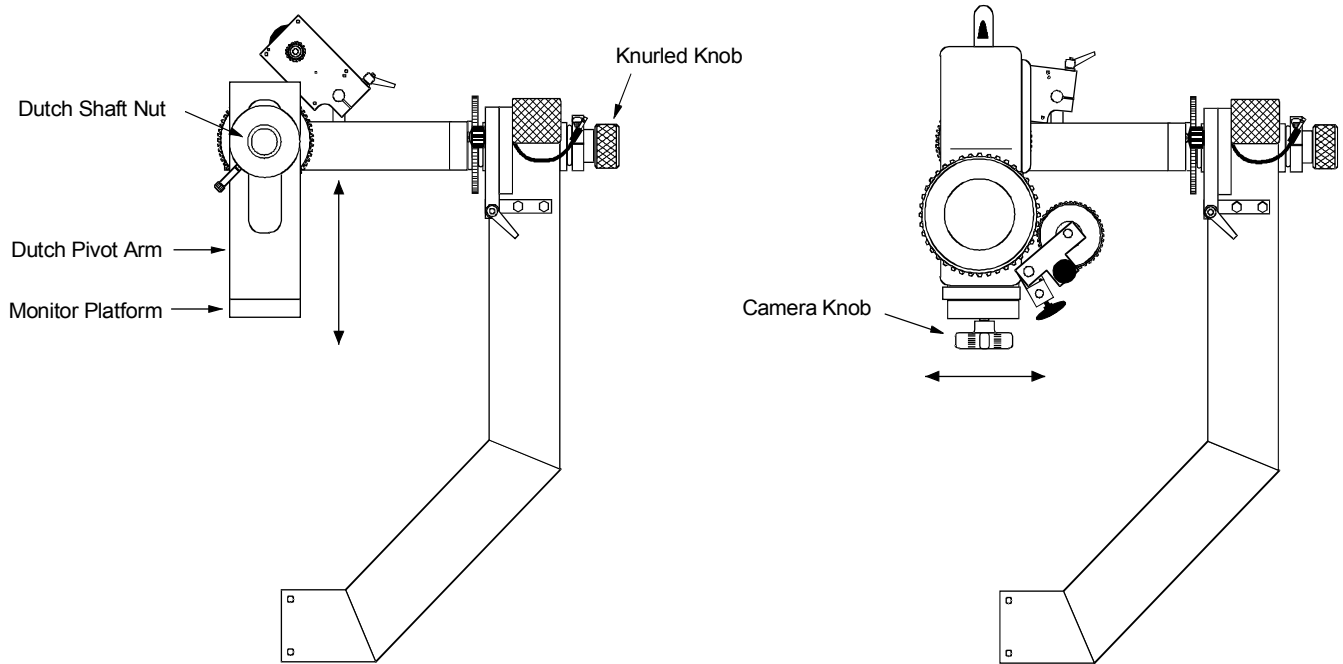

Once the camera is completely balanced you should be able to rotate and tilt the camera into any position and it should remain in that position.

DUTCH ROCKER POT

This control is similar to a zoom rocker and is attached to the side of the Zoom Focus Handle using the provided lid screws.

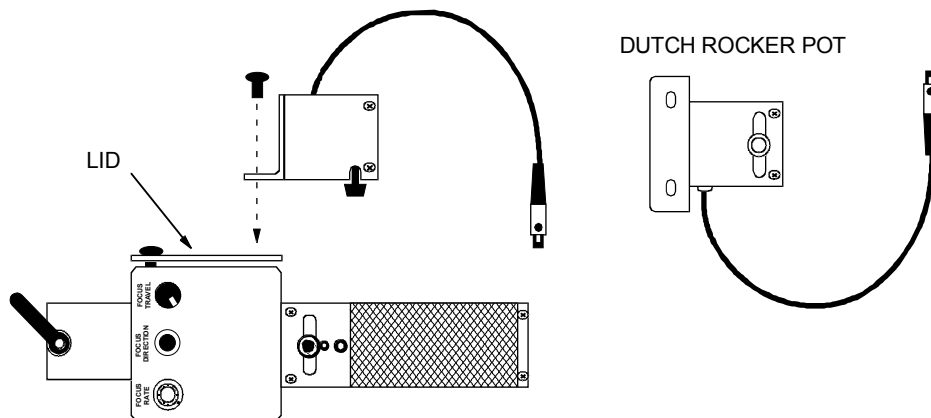

MOTOR CONTROLLER

SPEED: Operates the same as the Speed adjustment on the Jimmy Jib Head or the zoom rate control. This pot reduces the maximum speed of the dutch motor.

RAMP: Acceleration ramp that cushions the starting and stopping of head. Once again it operates the same as the Jimmy Jib Head.

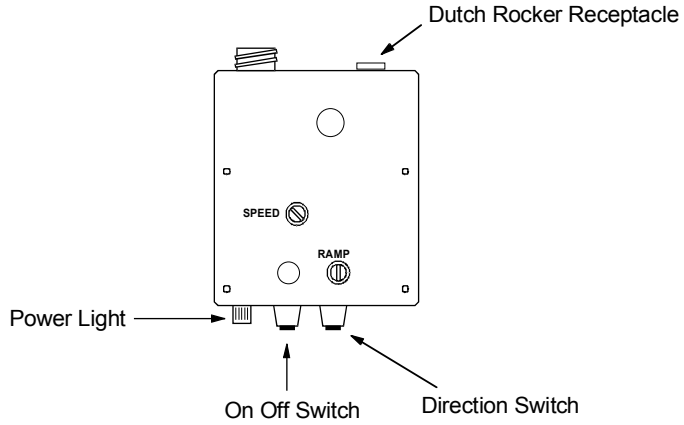

ELECTRICAL CABLE CONNECTIONS

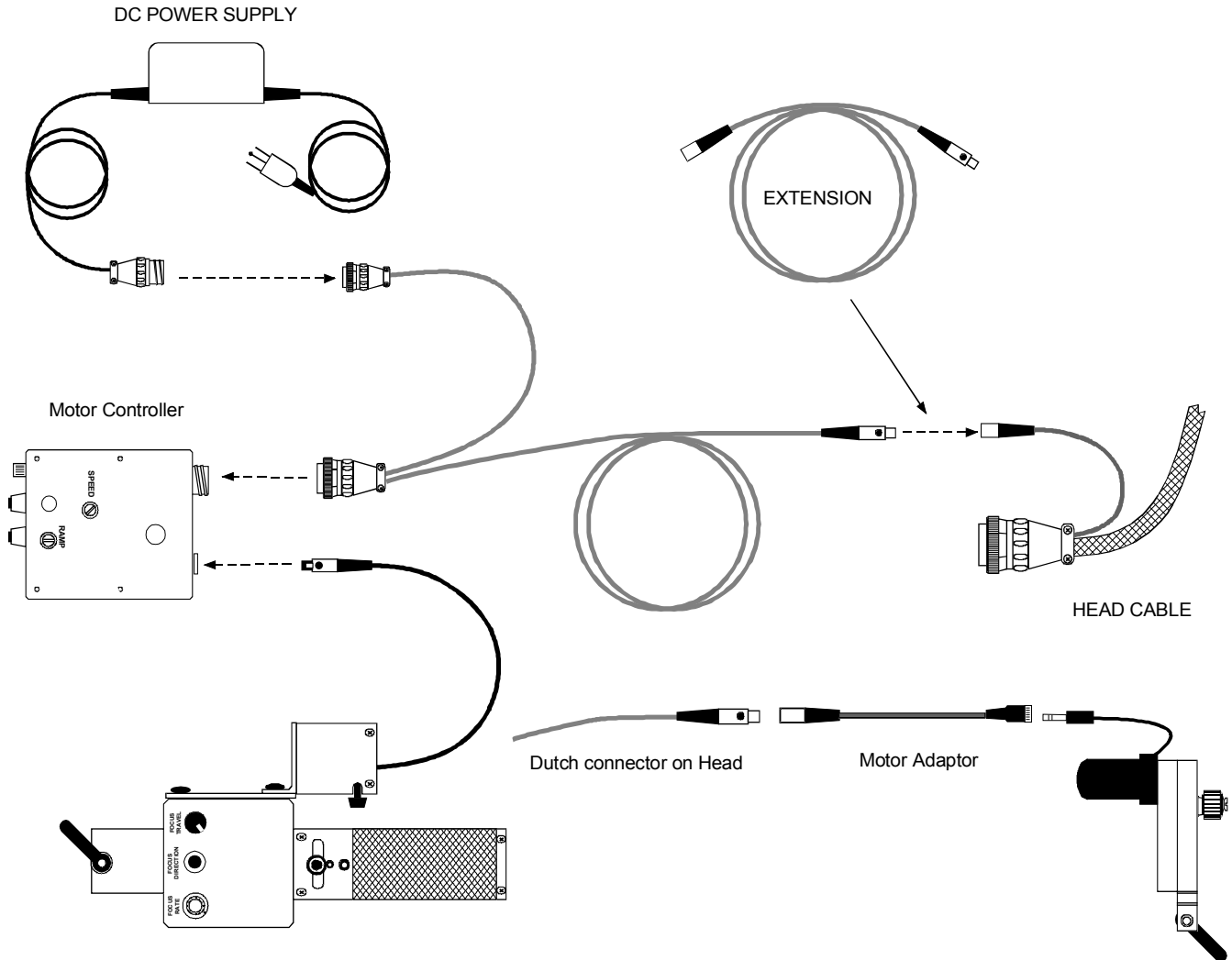

The Cables that come with the Dutch Head Kit allow the Kit to be used on all Jib sizes out to the Extreme. The Dutch Head cannot be used on the Jimmy Jib II (solid bar stock head).

NOTE: Current systems are built with an internal Dutch Head Cable and are labeled as such. If the 360 Dutch is to be installed on an early model head that does not have an internal dutch cable, an additional external extension cable will need to be purchased. Routing the external Dutch Cable through the Pan Shaft (on older heads) is the neatest method of running the cable. If the cable is run through the pan pivot then it will always remain on the Head. Installation through the pan pivot will require the removal of one connector so that the cable can be routed through the pan shaft and then reinstalled.

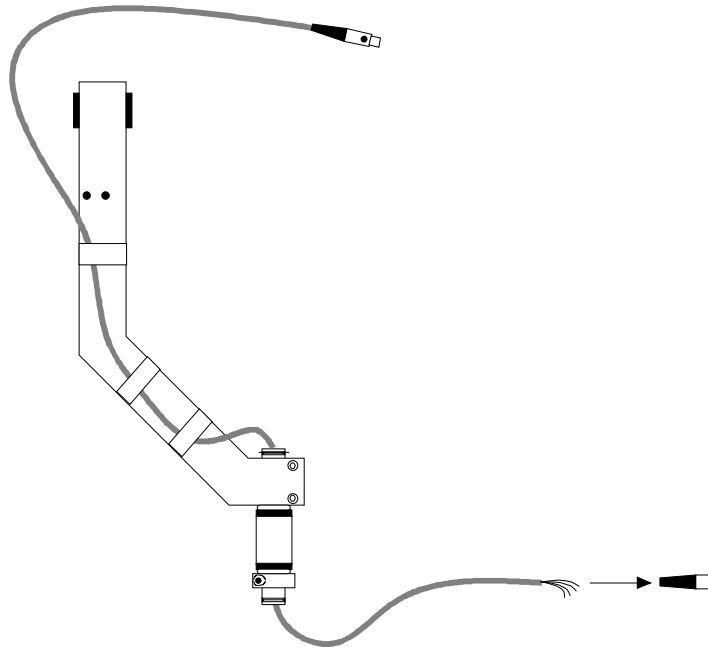

WARNING It is extremely easy to over twist the dutch control cables. Unlike the pan axis where you are panning one way then back the other; with the dutch it is easy to go around and then around again. Two consecutive 360's are acceptable but you do not want to go around a third time. You must keep an eye on the cables or remember how many revolutions you have made.

NOTE: If you wish to run the Dutch on battery power it will be necessary to power it from a separate battery pack. It was found that when trying to power the Dutch and the Stanton Head from the same battery pack the batteries would drop so quickly that it was impractical to power them both from a single battery pack.

360 DUTCH Wiring Diagram

